

TRANSCEND™

XPLÖR

265BH

PRODUCTION DATE 3/11

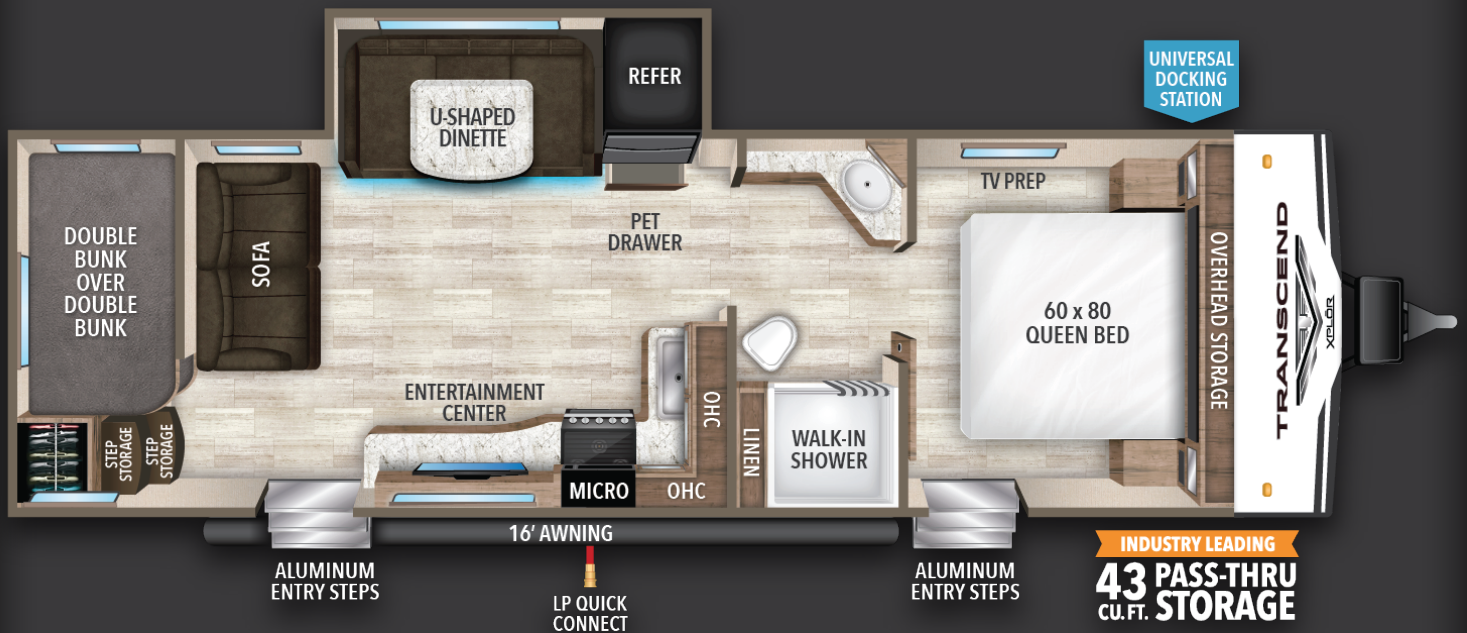

FEATURES

- ★ U-Shaped Dinette
- ★ Class-Leading 16' Power Awning
- ★ Utility Center in Pass-Thru
- ★ Bunk Room with Ward and Step Storage

TOP 10 FEATURES

- ▶ Aluminum Entry Steps
- ▶ Solid Wood Cabinet Doors and Drawer Fronts
- ▶ Motion Sensor Lights in Entrance and Pass Thru
- ▶ Ductless Flooring Throughout
- ▶ Residential Master Suite with 60"x 80" Queen Size Bed w/ Struts
- ▶ Quick-Drop Tongue Jack
- ▶ USB Ports in Convenient Locations
- ▶ Heated and Enclosed Underbelly
- ▶ Thermo (SurFX) Wrapped Countertops Throughout
- ▶ Industry Leading Tank Capacities

ADDITIONAL FEATURES

- ▶ R-9 Roof | R-9 Walls | R-11 Floor
- ▶ 78" Interior Height
- ▶ Deep Seated Stainless Steel Sink
- ▶ Industry Leading 43 cu. ft. pass thru storage space
- ▶ Friction Hinge Entry Door
- ▶ True Flush Floor
- ▶ Magnetic Storage Door Catches
- ▶ Walk-In Shower
- ▶ Large Swing-out Grab Handle
- ▶ Prepped for Rear Ladder
- ▶ Black Tank Flush

SPECIFICATIONS

UVW (lbs.)	TBD lbs.	Awning Size	16'
Hitch Weight (lbs.)	TBD lbs.	Fresh Water (Gal.)	62 gal
Exterior Length	32' 9"	Gray Water (Gal.)	68 gal
Tire Size	15" D-Rated	Waste Water (Gal.)	39 gal

* R-Value Equivalent

Because of our commitment to continuous product improvement, Grand Design Recreational Vehicles reserves the right to change components, standards, options, specifications, and materials without notice and at any time. Photos may show optional equipment which may not be included in the standard purchase price of the featured unit. Be sure to review current product details with your local dealer before purchasing.

GRAND DESIGN
RECREATIONAL VEHICLES

